

THE
FENGSHUI AGENCY
transforming spaces, naturally

Master Planning Feng Shui Case Study 2

East Village, Antigua

Commissioned by Mimosa Developments



Macro Perspective

- Our analysis incorporated the details provided by Environmental Impact Assessment report from the local Coastal Protection Commission. We supported and expanded upon the ecologically sensitive approach of the owner and encouraged that rare species be relocated and as much of the natural flora be maintained as possible to help protect the beautiful peaceful feel and also to maintain the stability of the earth in the rainy season, rather than opt for the banal 'golf course style' trimmed lawn approach of many resorts.
- A site visit was necessary to confirm the Magnetic North, as opposed to the Compass North, and to sense the general feeling of the site





designing the site

- Working in collaboration with OBM Master Planners we greatly improved the entrance or 'chi mouth' to the site making it more ergonomic and even freeing up extra space for development. Feng Shui can help make your project more profitable right from the start!
- Advised on ideal positions for beach club, utilities and staff accommodation.



- Entrances are the 'mouths of chi' and are best in Vitality positions. Conversely, exits (exit roads and/or drainage) are best in Sickness positions (to carry negative chi away from rather than towards the site)



Beach Club Design

- The original Beach Club design (right) of the master planners had an excessive amount of water features and pools, particularly on the high ground. Again, we helped our client save money in the longer term by minimising the amount of water features – they are expensive to maintain.
- We also advised on the optimum orientations for the main buildings and the location of the sales offices.

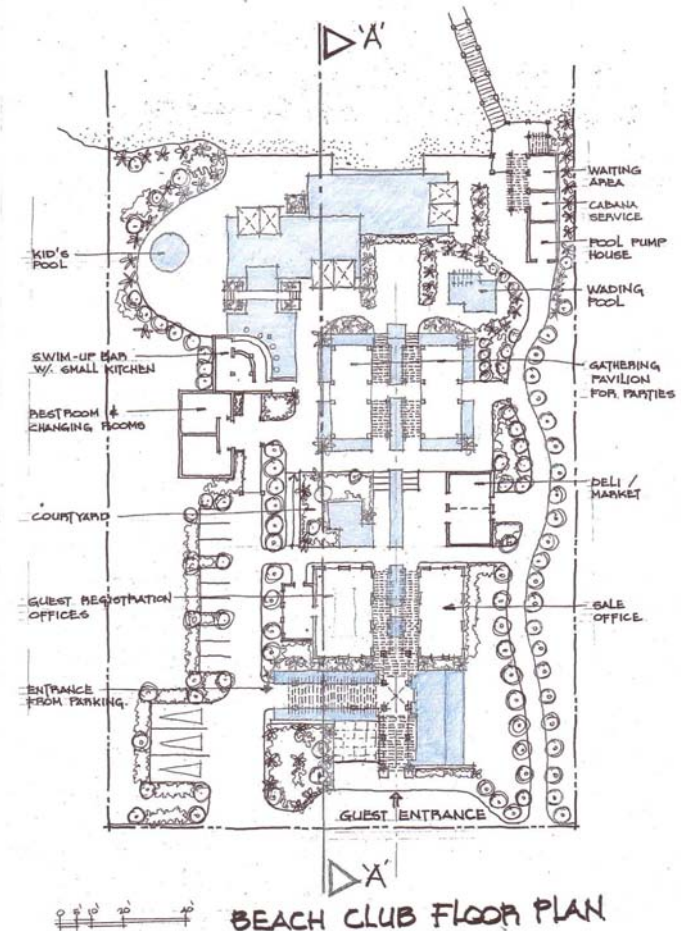



Origins of Feng Shui

- While *Feng Shui* originated in China over 5000 years ago, it has universal application, and is not dependent on any religious belief. Its roots can be found in the simple *nature awareness* of agricultural farmers and also the scholarly influence of astrologers and government advisers to the Imperial families of China.
- *Feng* (pronounced fung in Cantonese or fong in Mandarin) literally translates as wind and *Shui* (pronounced tsoy or shway) means water. Chinese concepts are famously poetic, and these terms refer to concepts of energy dynamics within the universe.
- *Feng* is the wind that can disperse or stimulate energy, and *Shui* is water that can hold and harmonise energy.
- *Feng Shui* is the original ecological design and can be used as a vehicle to understand our interconnectedness with nature on a physical and spiritual level.